

SRL Mounting Details

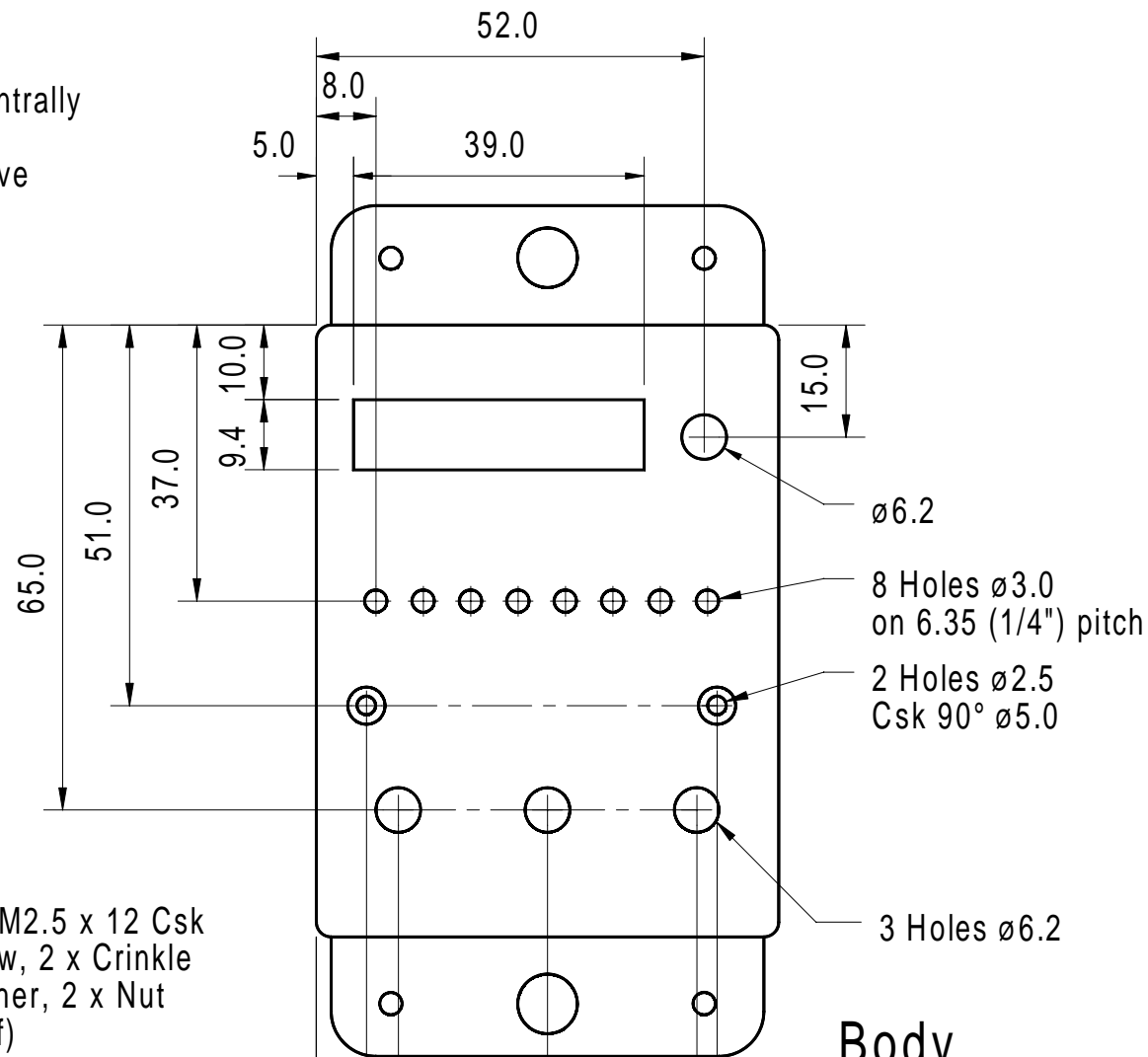

Body

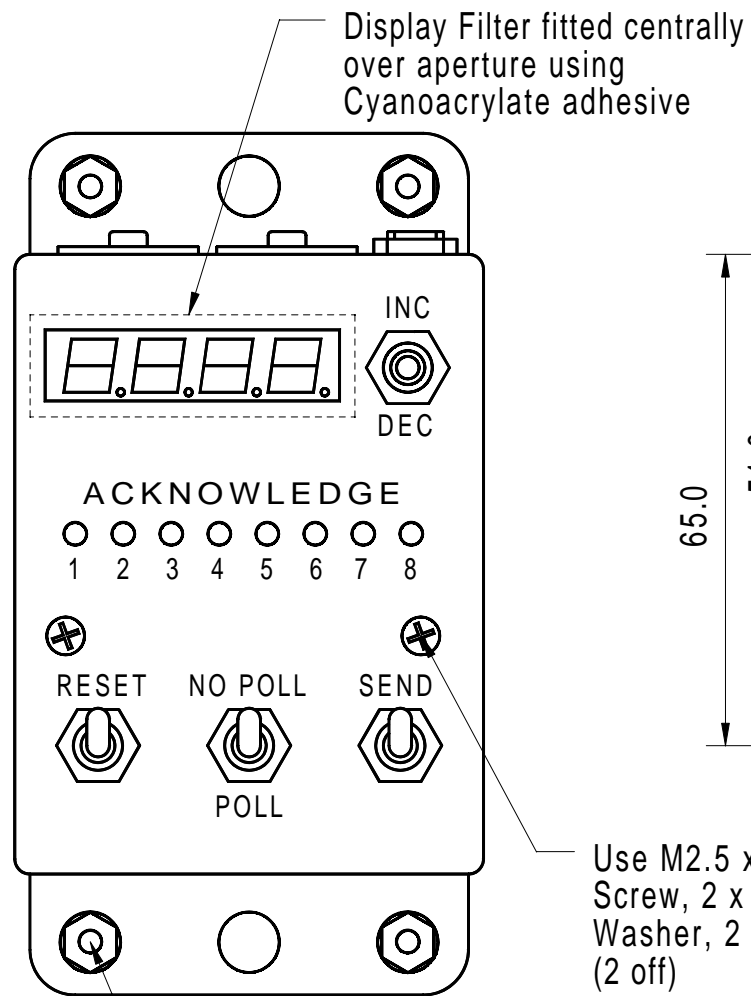
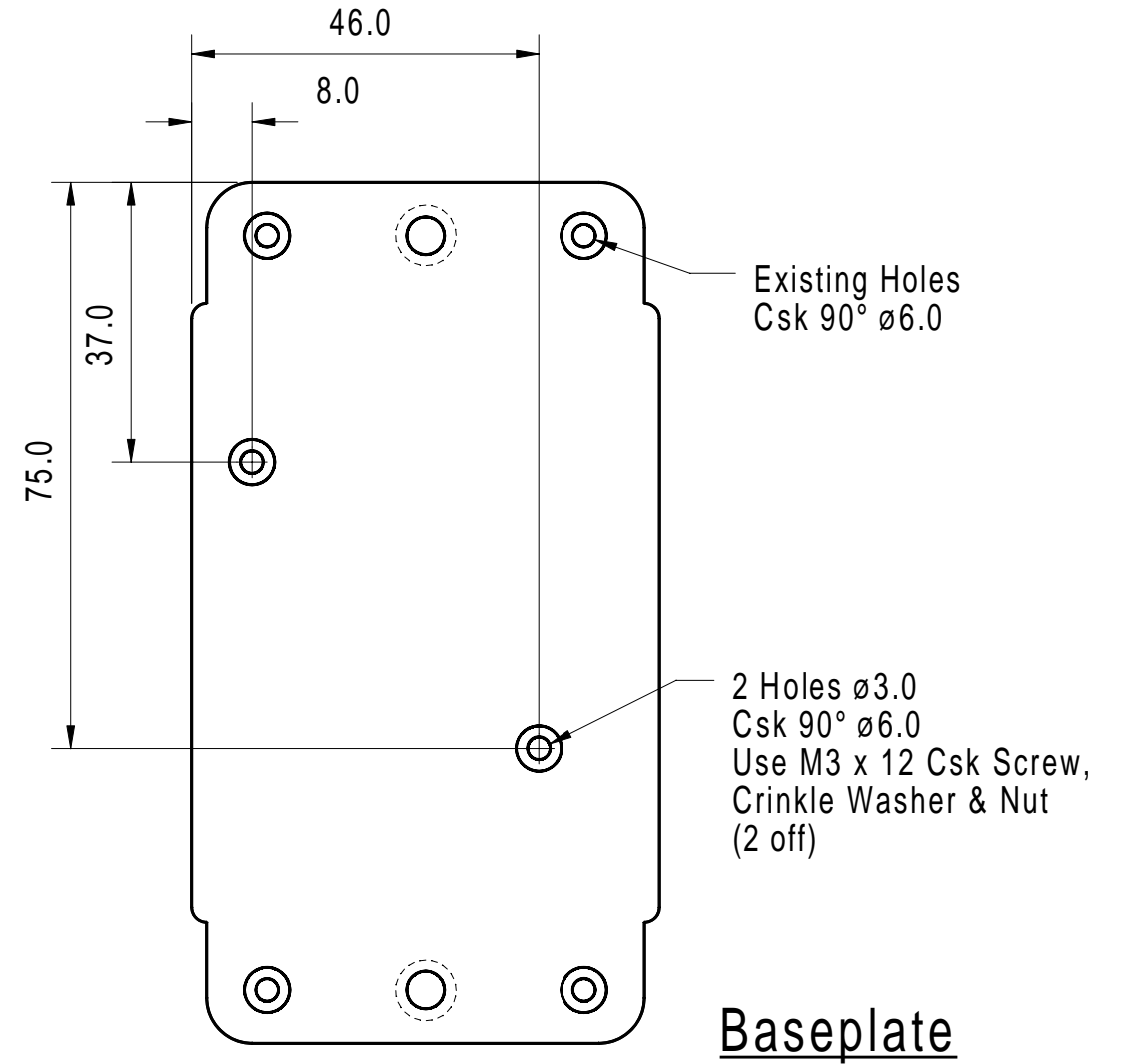

Baseplate

Use M3 x 6 Csk Hd Screw, Crinkle Washer & Nut (4 off)

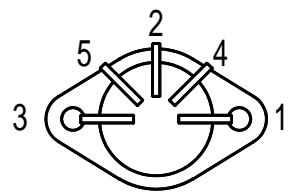

DIN Socket Pinout (from wiring side)

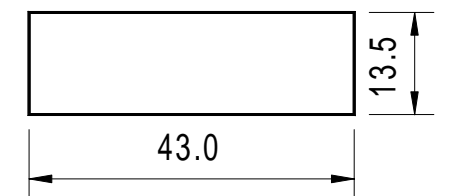
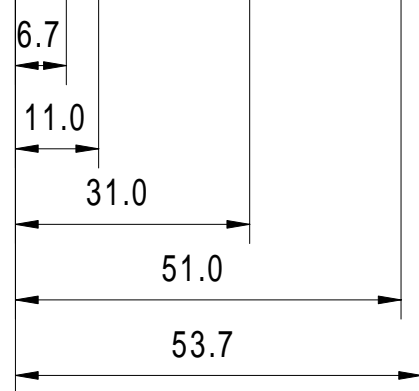

Display Filter Material

Holes countersunk on this face

RDD Control Station Machining, Assembly & Labelling

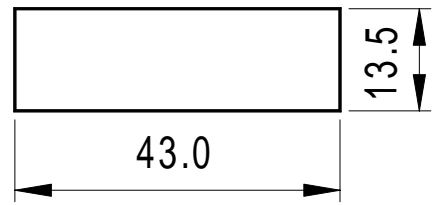

Display Filter Material

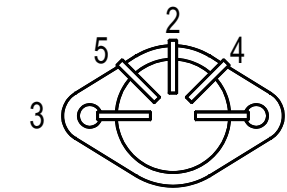

DIN Socket Pinout
(viewed from wiring side)

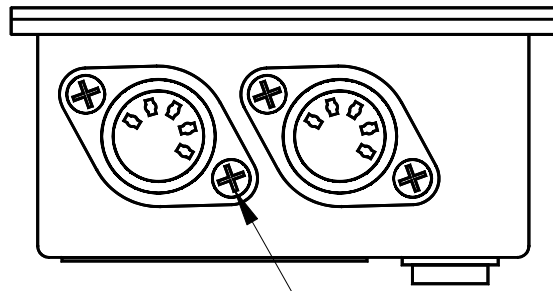

Use M3 x 12 Pan Hd Screw,
Crinkle Washer & Nut (4 off)

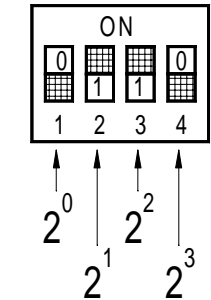
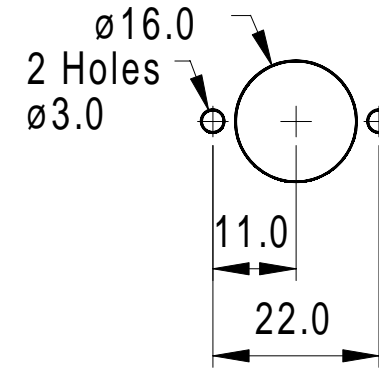
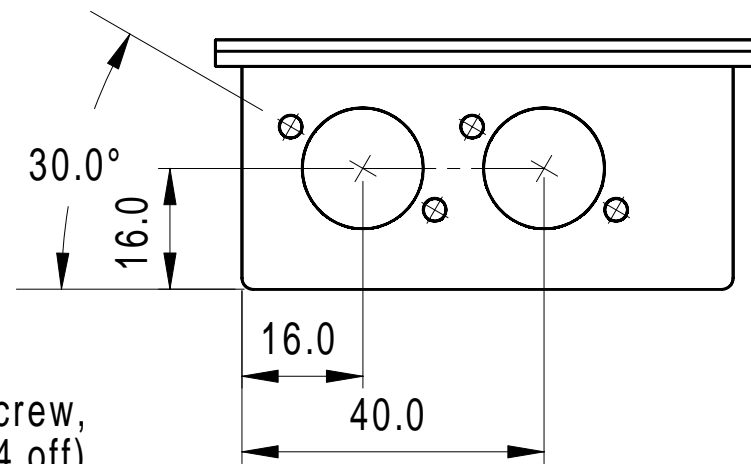

$$\begin{array}{r}
 0 \times 2^0 = 0 \\
 1 \times 2^1 = 2 \\
 1 \times 2^2 = 4 \\
 0 \times 2^3 = 0 \\
 \hline
 \text{Address } 6
 \end{array}$$

Address Switch S1
Setting Example

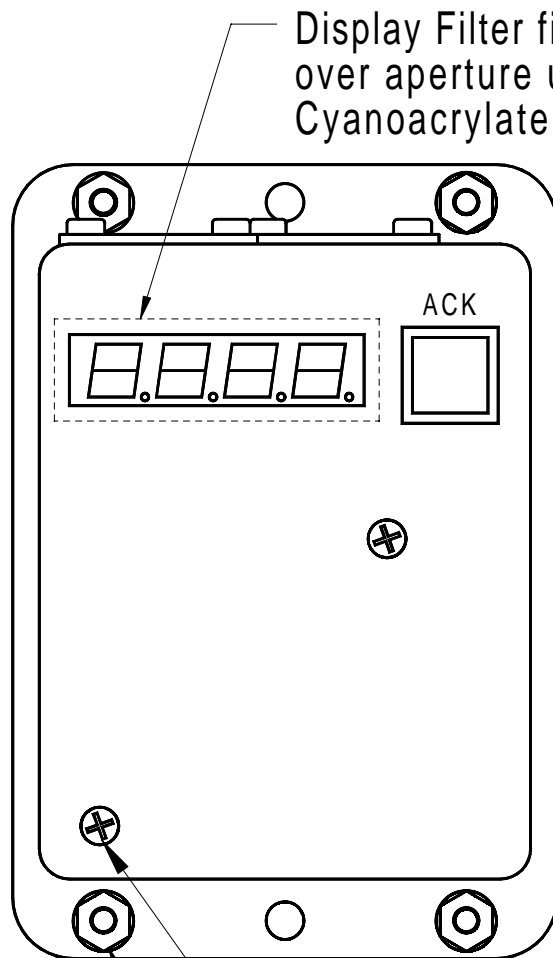

Display Filter fitted centrally
over aperture using
Cyanoacrylate adhesive

Use M3 x 12 Csk Hd Screw,
Crinkle Washer & Nut (2 off)

Use M3 x 6 Csk Hd Screw,
Crinkle Washer & Nut (4 off)

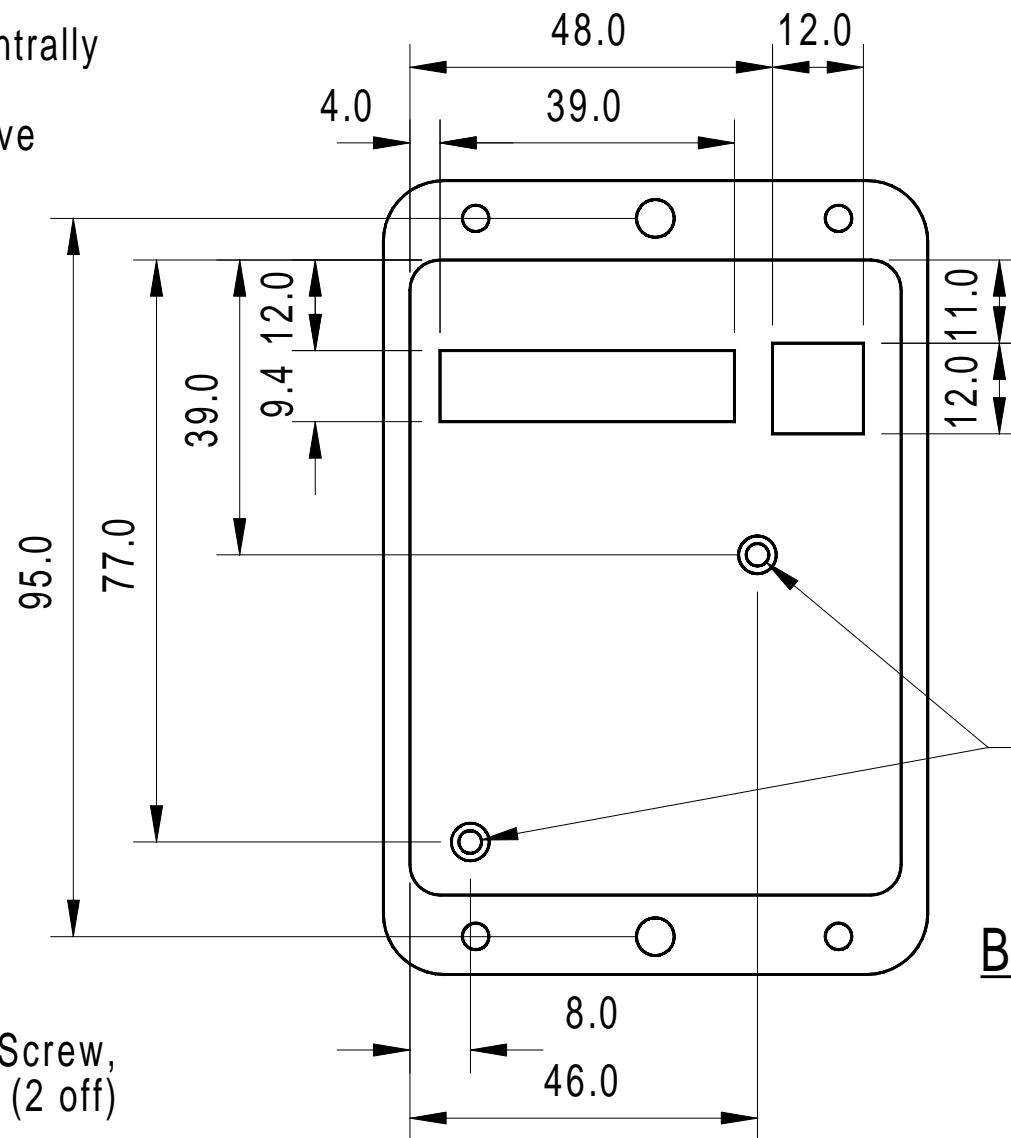

Body

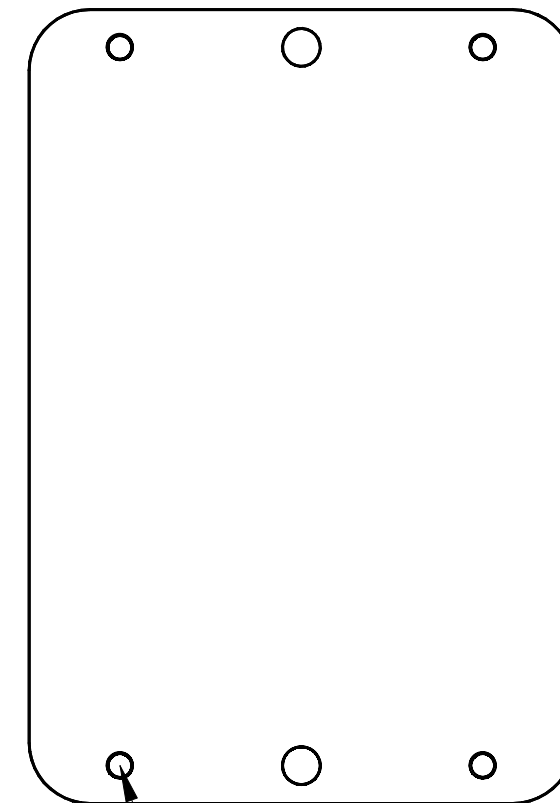

Baseplate

Drill out existing spigots ø3.0,
Csk ø6.0 on reverse face (bottom)
(4 off)

RDD Display Station Machining, Assembly & Labelling